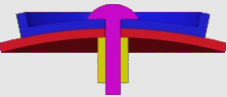
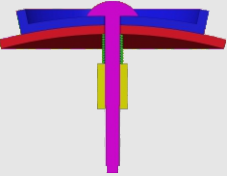
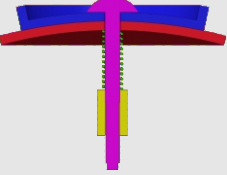
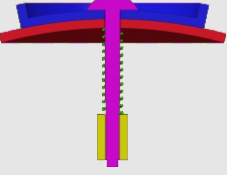

How to tighten the screws

Find your model in the table

Assembly section	Tightness	Models
	tight (no spring)	#61,#75
	tight (spring in green) (Short screw is recommended)	#72,#73,#77,#87,#88 #89
	medium (spring in green)	#94,#93,#90,#86,#85 #83,#82,#81,#80,#79 #78,#76,#71,#70,#69 #68,#67,#66,#65,#64 #63,#62,#60,#59
	loose (spring in green)	Mostly applicable to 'medium' category. Not recommended in general.

1. Tighter is usually better since the spring we provide is soft.
2. Early products had been using longer screws. You can either insert thick washer when necessary or request for short screws in the <Accessory & free parts> directory at our homepage:
<https://www.verypuzzle.com>

VeryPuzzle
2024/04

VeryPuzzle

Rhombic Triacontahedron V1.0-F1

RT5-F1

#64



700+ parts
30 axes

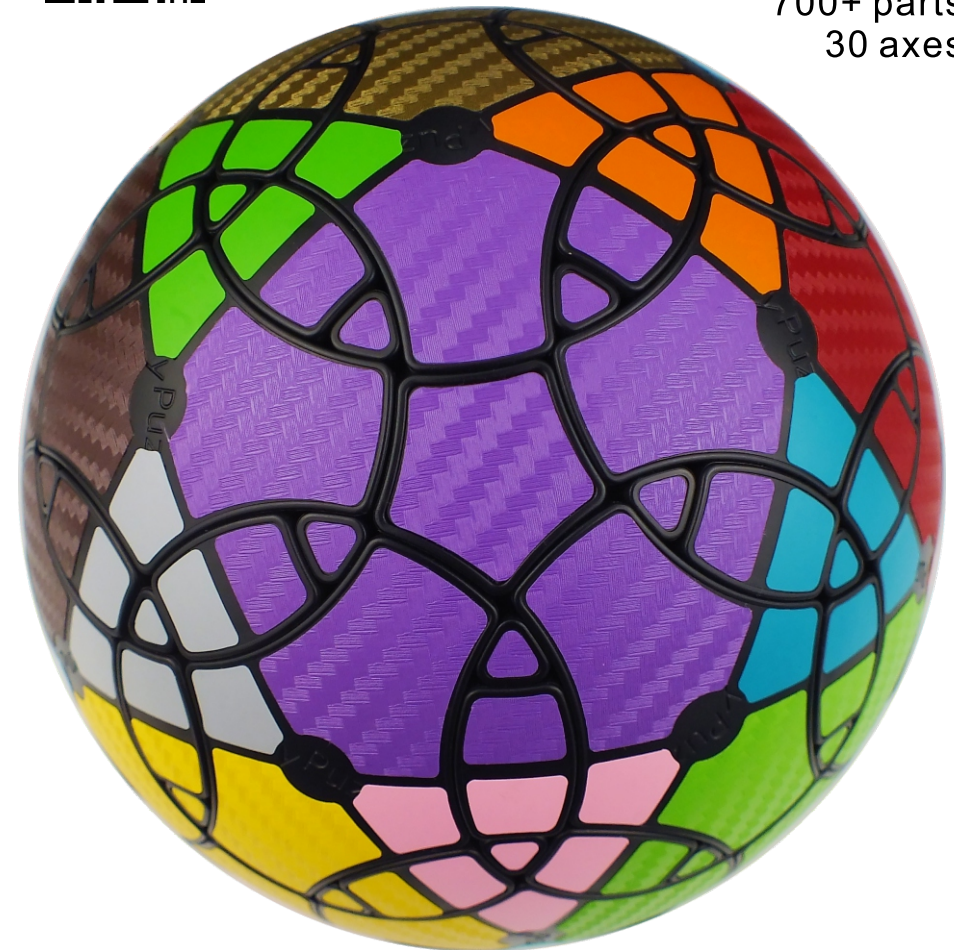

1

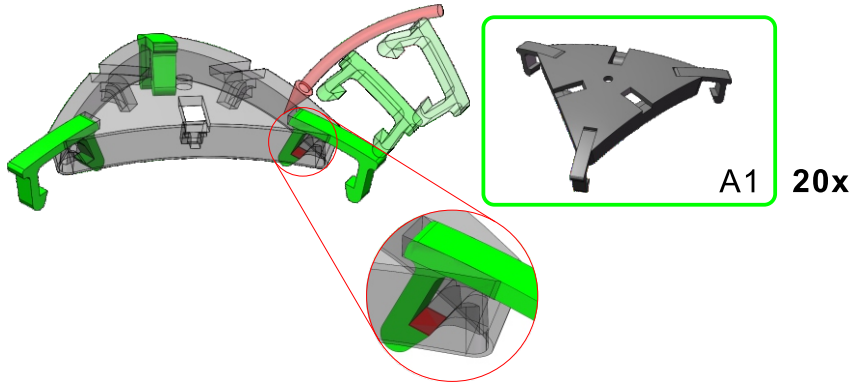

2

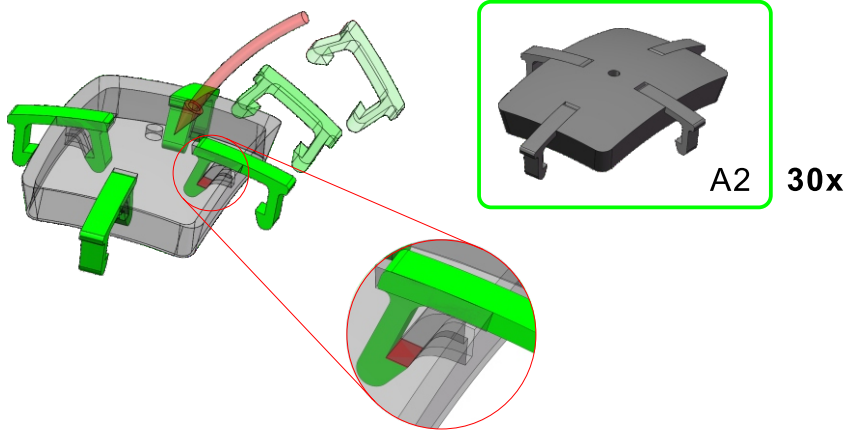

3



screw tension
no tension 0 1 2 3 4 5 6 7 8 9 tight

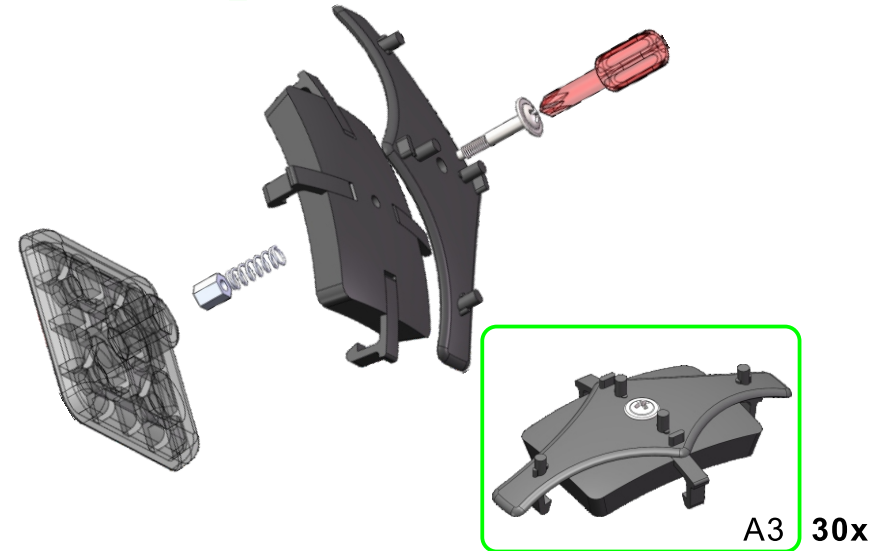

4

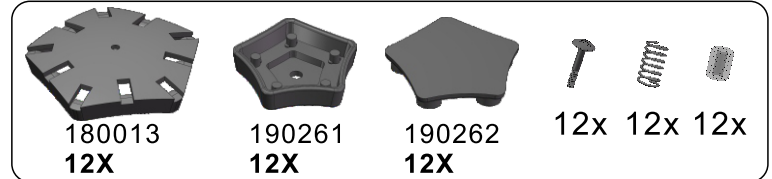

screw tension
no tension 0 1 2 3 4 5 6 7 8 9 tight

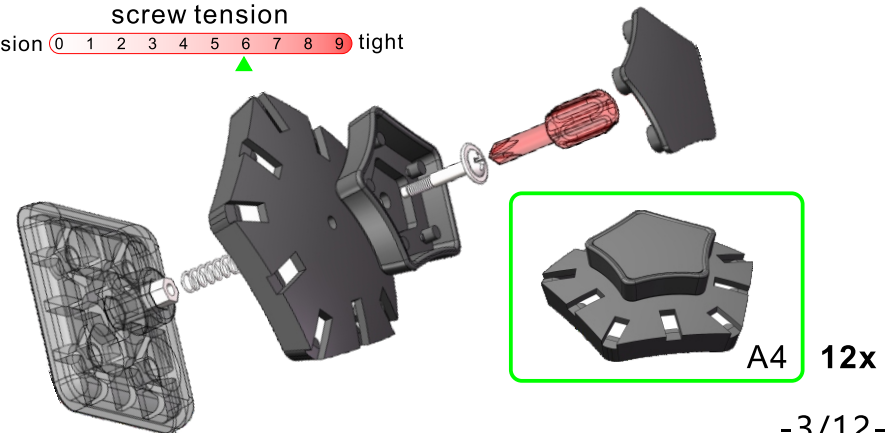

5

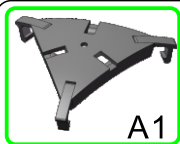

A1 20x

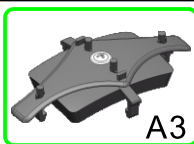

A3 30x



A4 12x

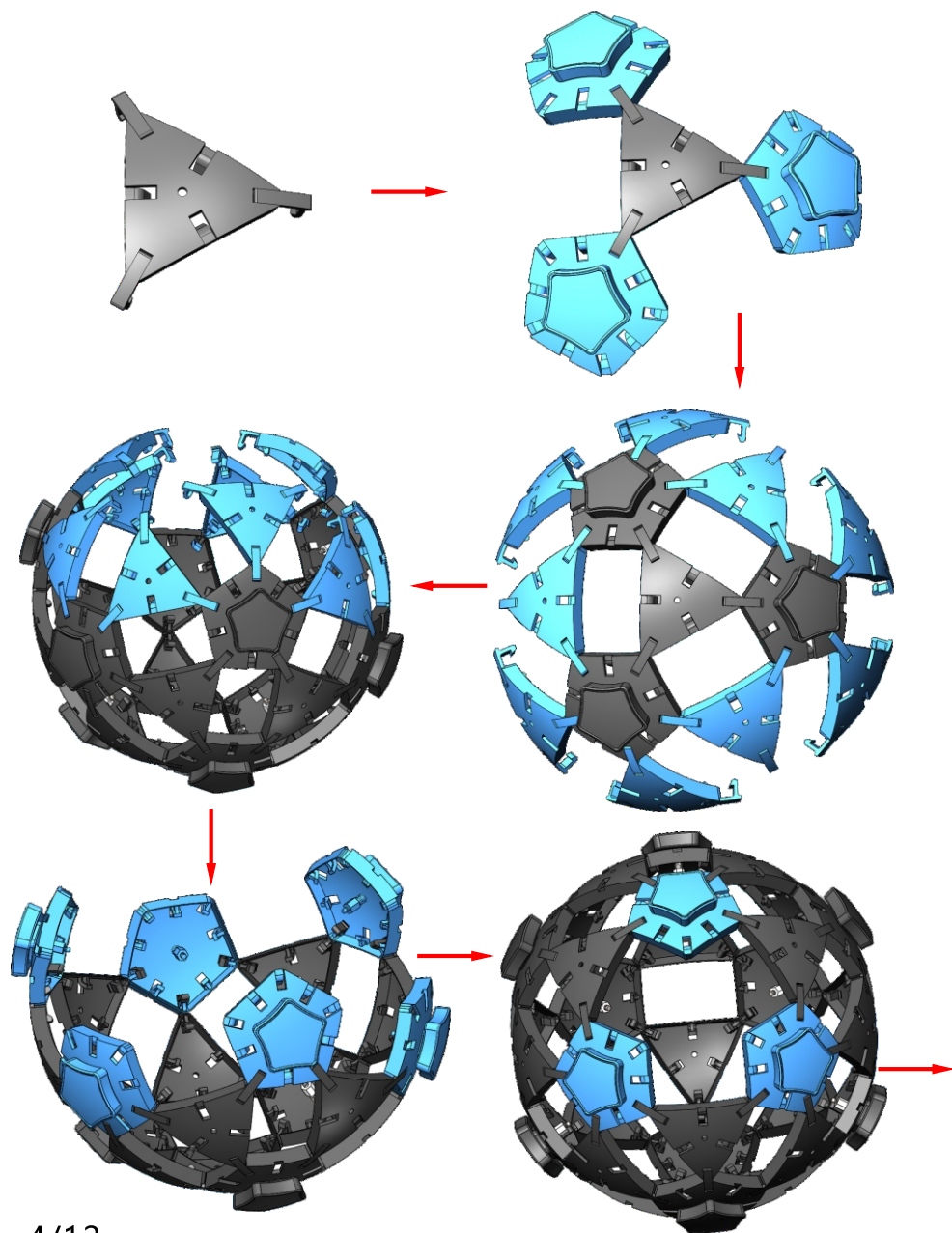

-4/12-

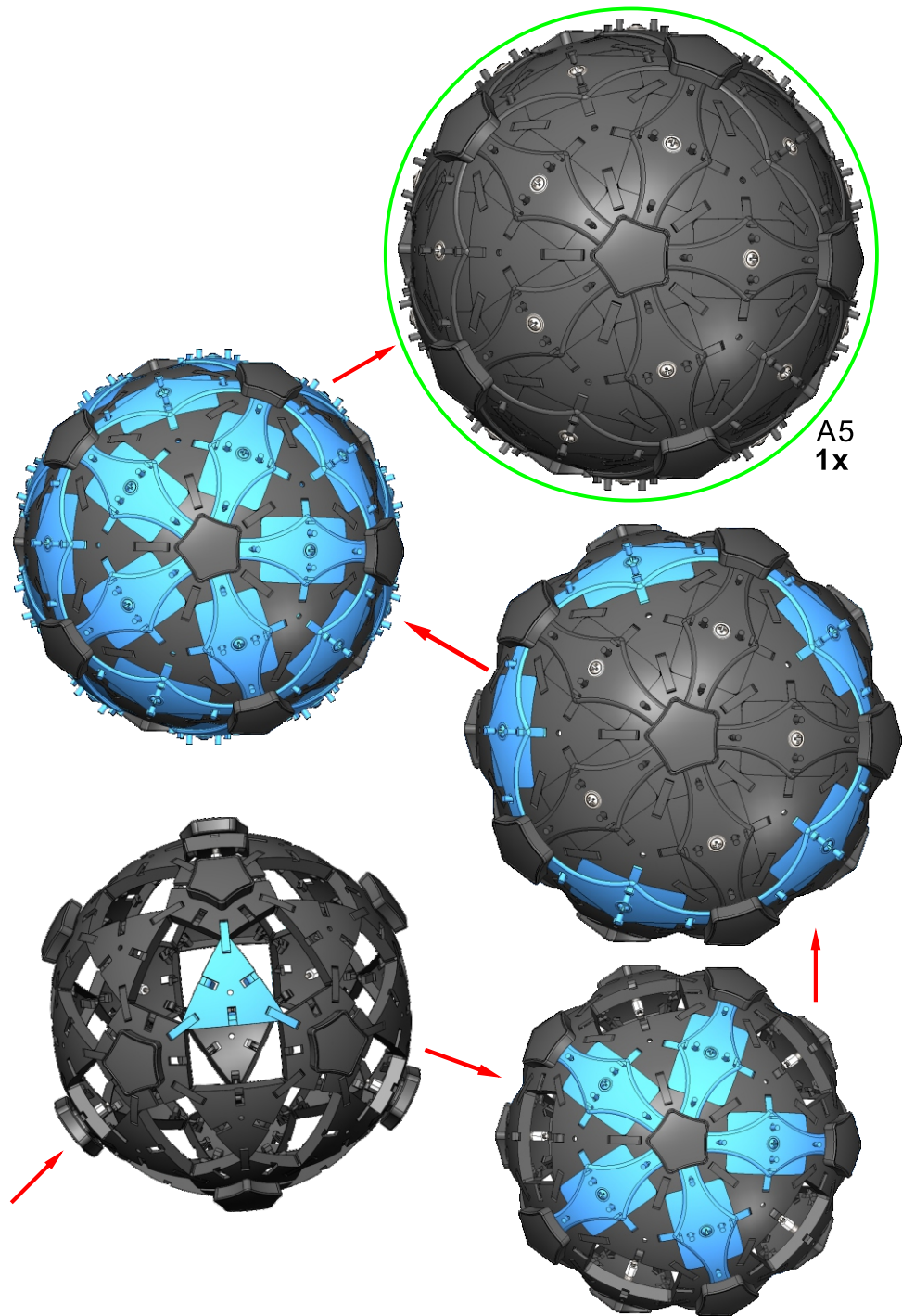

A5
1x

-5/12-

6



190491
190492
60X



190493
190494
60X

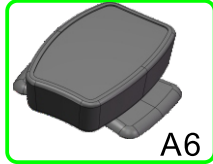
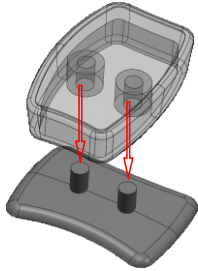

A6 60x

7



190272
190274
190276
80X

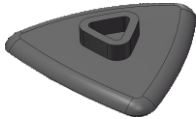

190271
190273
190275
80X

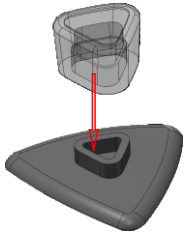

A7 80x

8

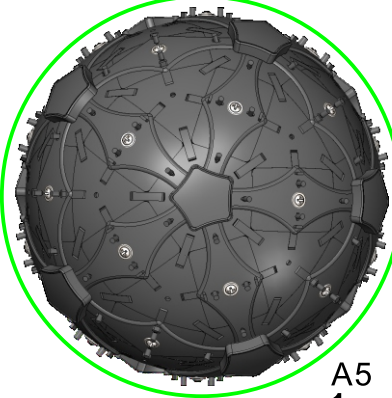

A5
1x



190221
30X

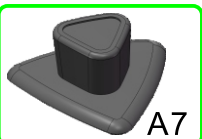

A7 80x



A6 60x

8

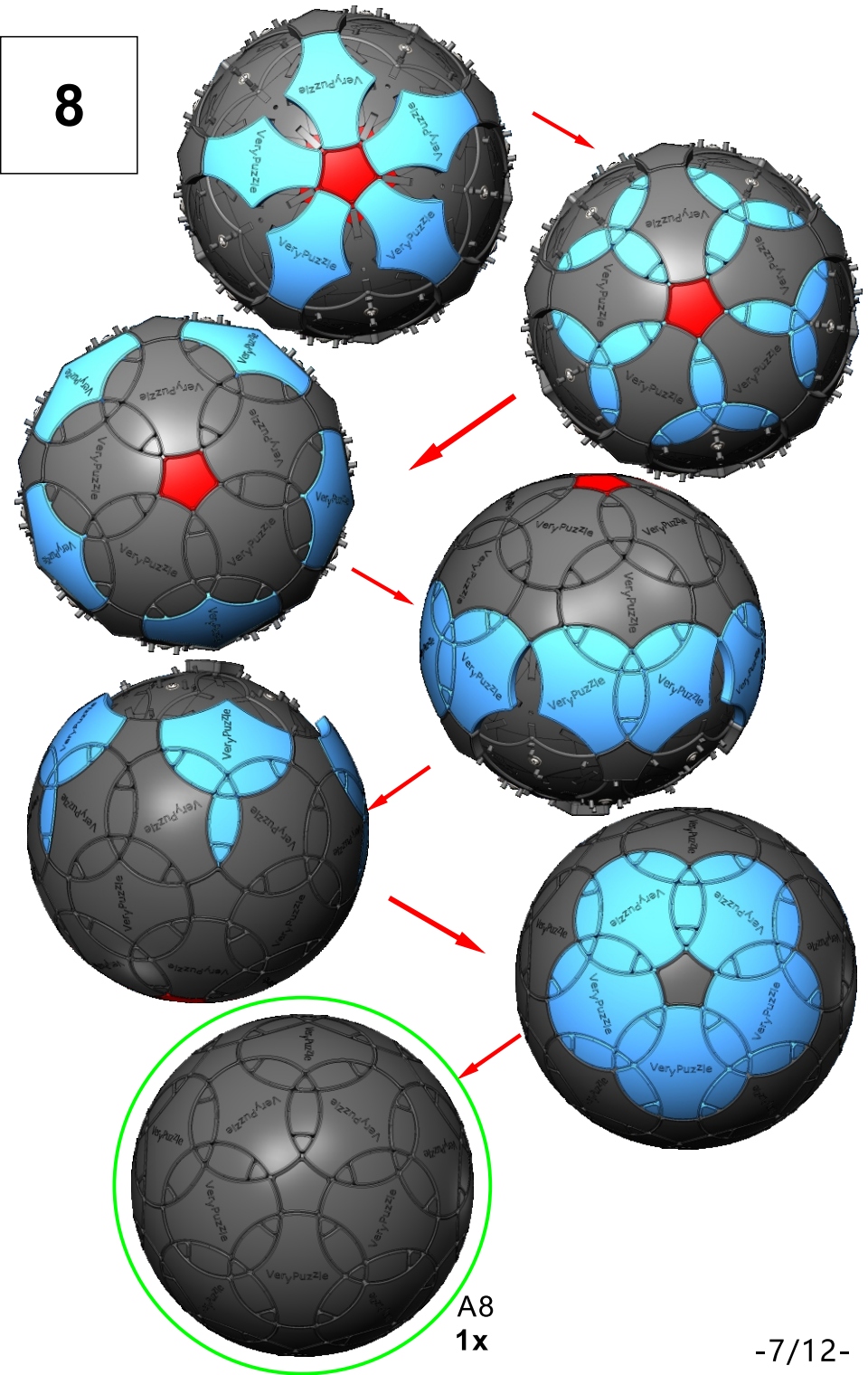

A8
1x

9

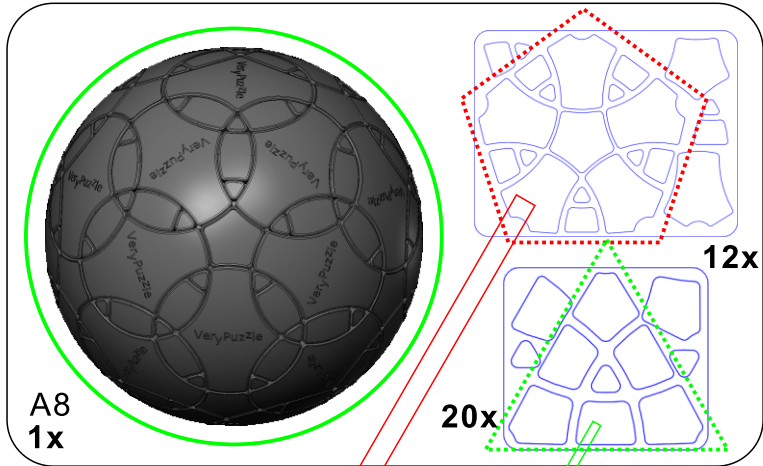

Clean part surface
before applying stickers



10

Rotation Rules

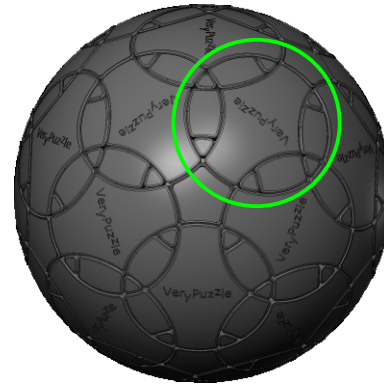

R4 symmetry
Turns $180 \cdot n$ degrees
Turns $180 \cdot n + 63.4$ degrees

Notations and Algorithms

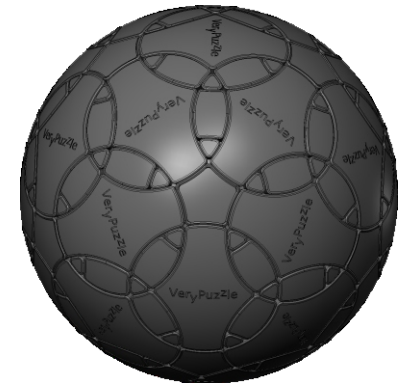
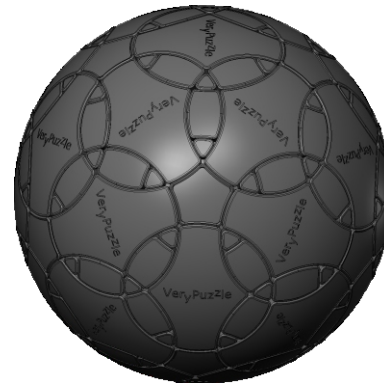

Notations and Algorithms

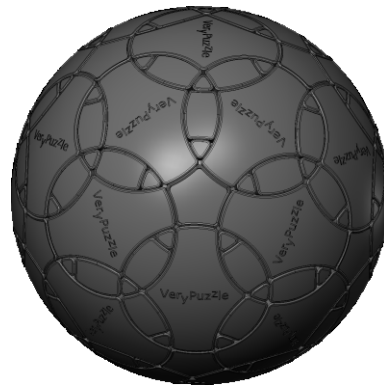
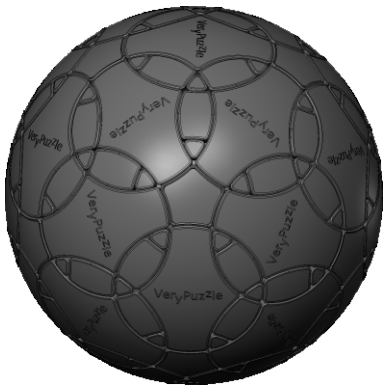
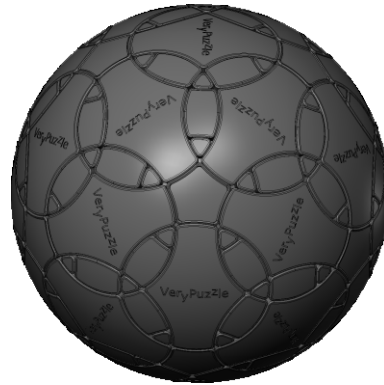
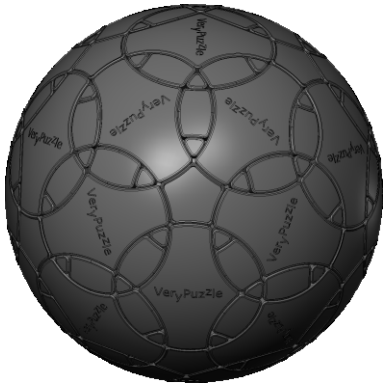

Product Information Card

Product Name	Rhombic Triacanthedron F1
Model NO.	#64
Design	VeryPuzzle Co., Ltd(HK)
Manufacturer	VeryPuzzle Co., Ltd(HK)
Year of release	2019
Maximum diameter	145 mm
Visible moving parts	182 pcs
Coloring strategy	Voronoi
Number of colors	32 colors
Sticker type	mixed Voronoi & Delauney
Sticker protection	Yes
Number of sticker pieces	332 pcs
Axis & Symmetry	RT(R4)
Maximum parts shared between two axes	3 parts
In-core spring	Yes
Adjustable tension	No
Technical Name	RT5-F1
Topological Print	RT24
Core specification	DIRT130



180012
20X

190221
30X

190261
12X



180013
12X

190231
30X

190262
12X



180011
30X

180X

190271
190273
190275
80X

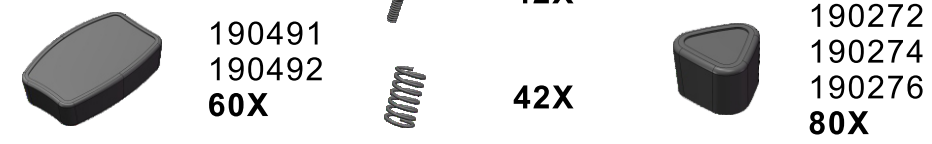

190491
190492
60X

42X

190272
190274
190276
80X



190493
190494
60X

42X



190621
1X

200011
1X

12X

20X

Customer Service

1. support@verypuzzle.com



VeryPuzzle