

How to tighten the screws

Find your model in the table

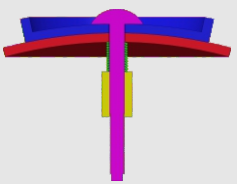
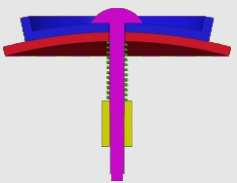
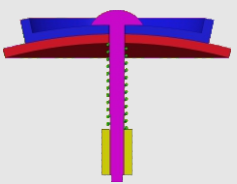

Assembly section	Tightness	Models
	tight (no spring)	#61,#75
	tight (spring in green) (Short screw is recommended)	#72,#73,#77,#87,#88 #89
	medium (spring in green)	#94,#93,#90,#86,#85 #83,#82,#81,#80,#79 #78,#76,#71,#70,#69 #68,#67,#66,#65,#64 #63,#62,#60,#59
	loose (spring in green)	Mostly applicable to 'medium' category. Not recommended in general.

1. Tighter is usually better since the spring we provide is soft.

2. Early products had been using longer screws. You can either insert thick washer when necessary or request for short screws in the <Accessory & free parts> directory at our homepage:
<https://www.verypuzzle.com>

VeryPuzzle
2024/04

VeryPuzzle



DIRT V1.0

尘 V1.0

#80

900+ parts
62 axes



1

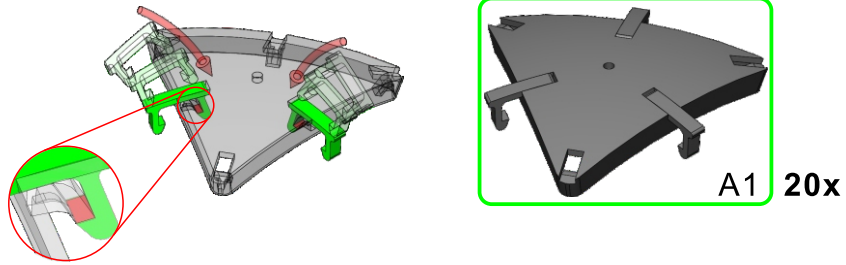

3

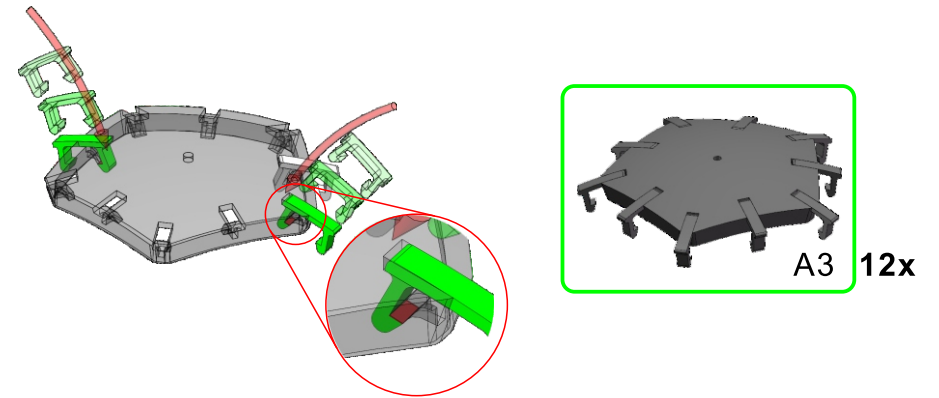

2

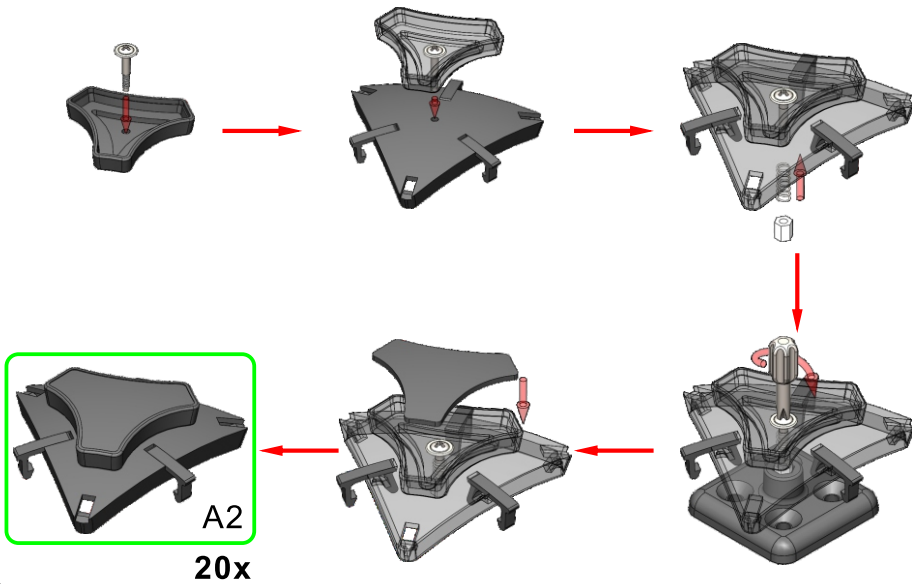
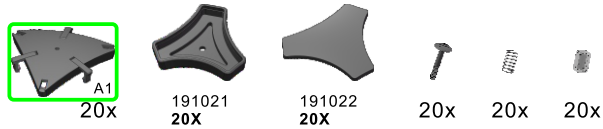

4

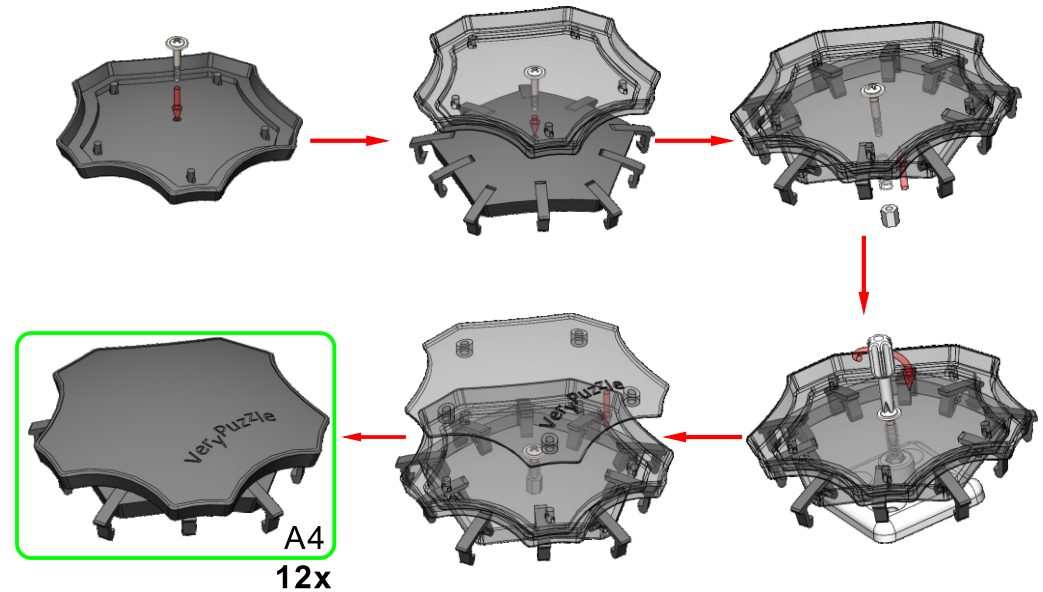
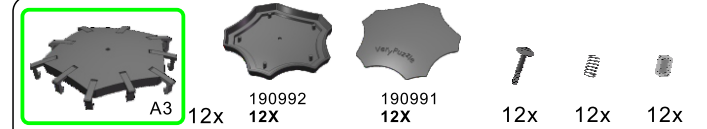

5

- 190033 30x
- 191011 191012 30x
- 191013 191014 30x
- 30x
- 30x
- 30x

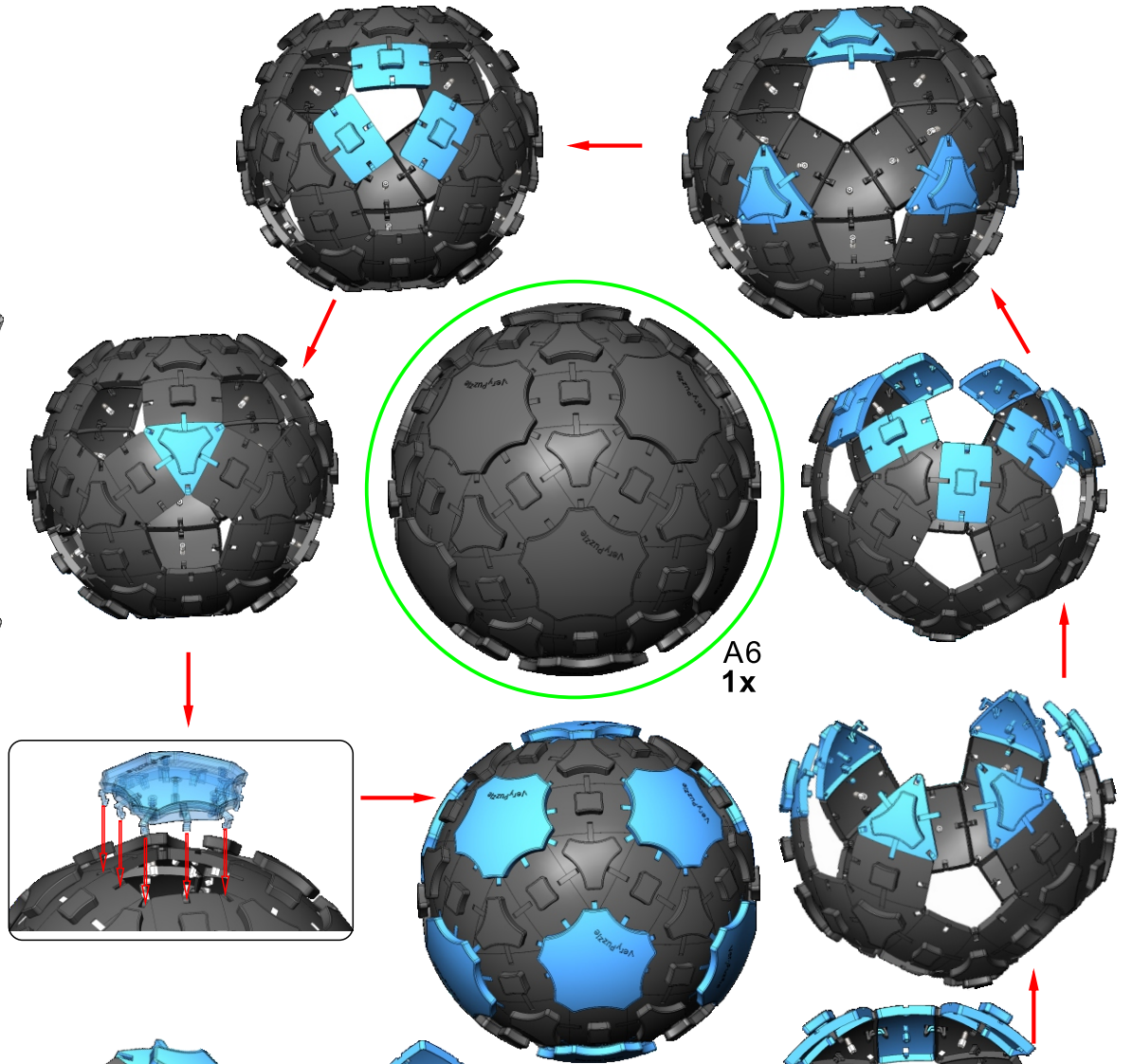
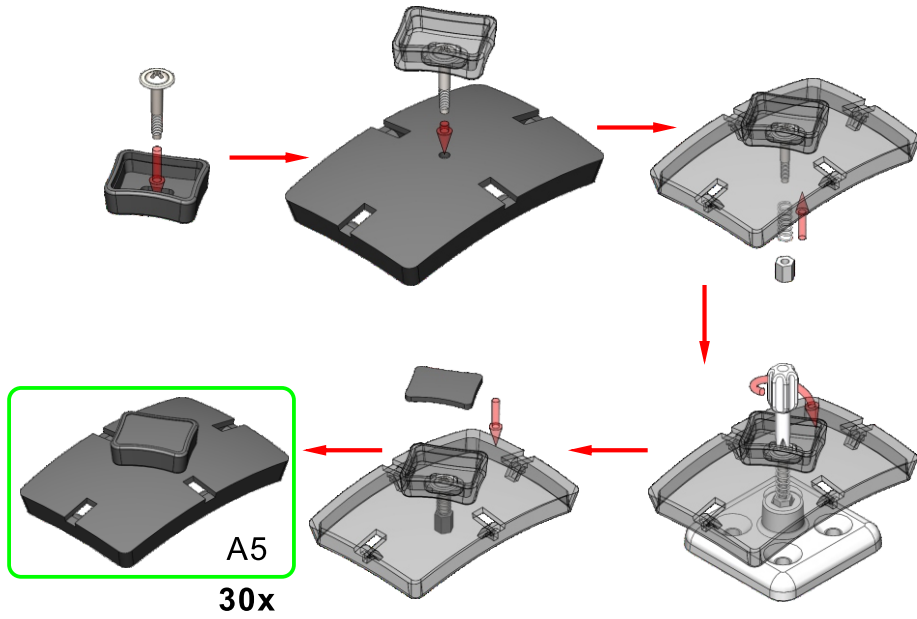

6

- A2 20x
- A4 12x
- A5 30x

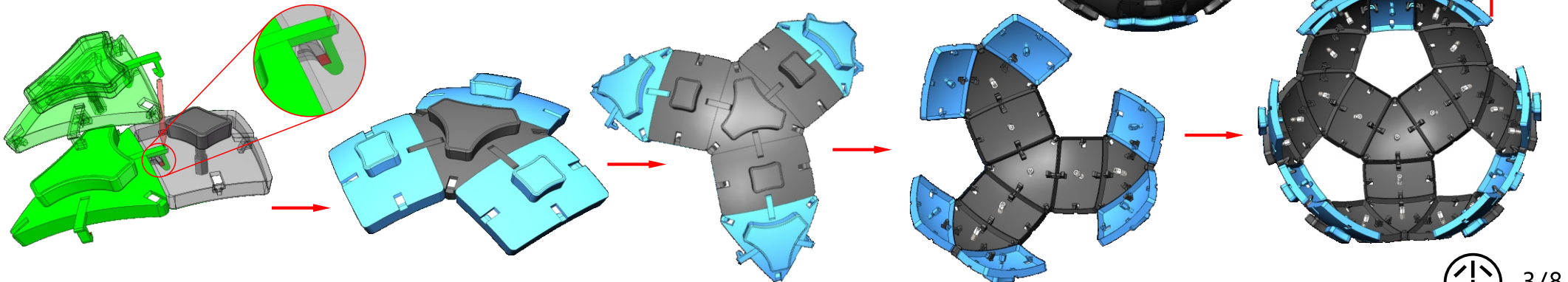

7

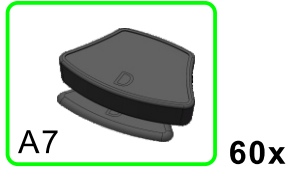
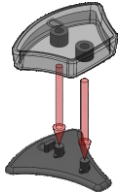

10

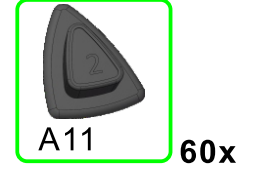

8

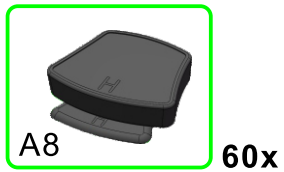
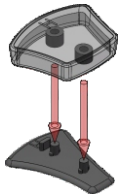

11

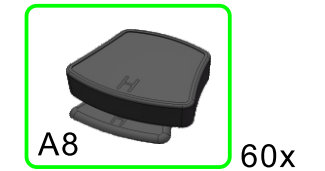
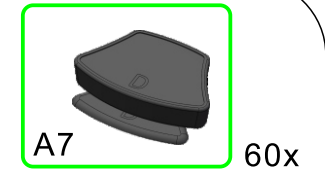
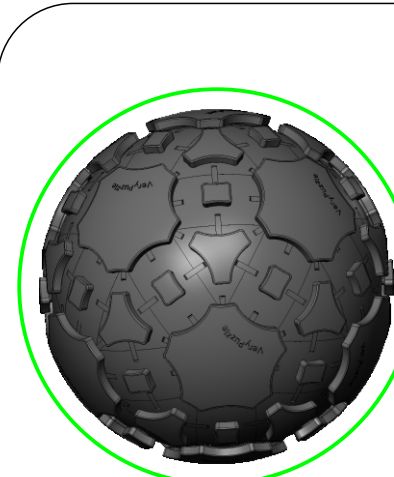

9

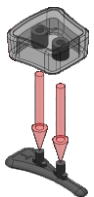

11

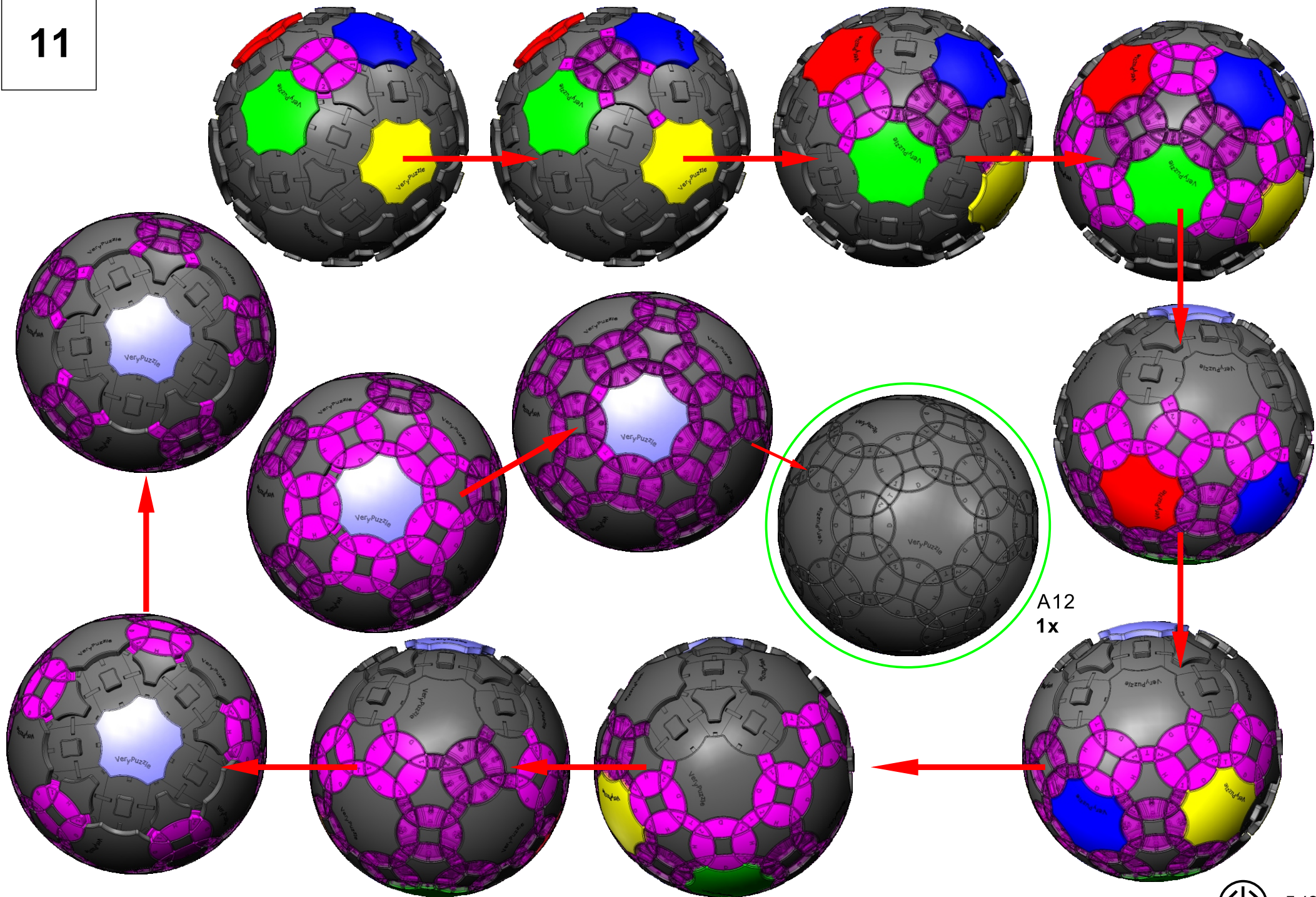

12

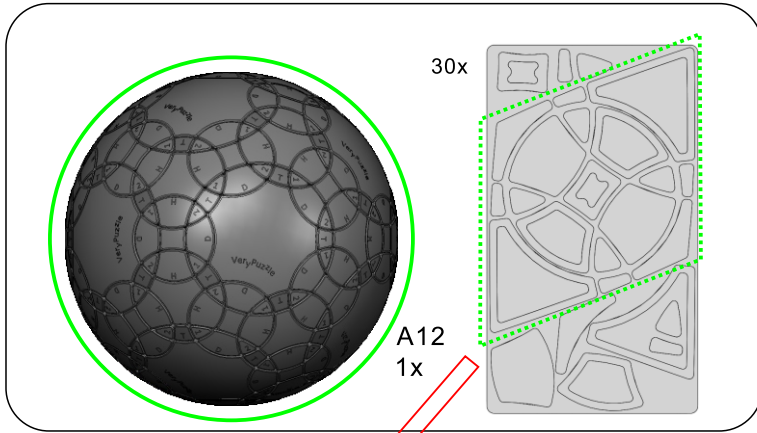

Clean part surface before applying stickers

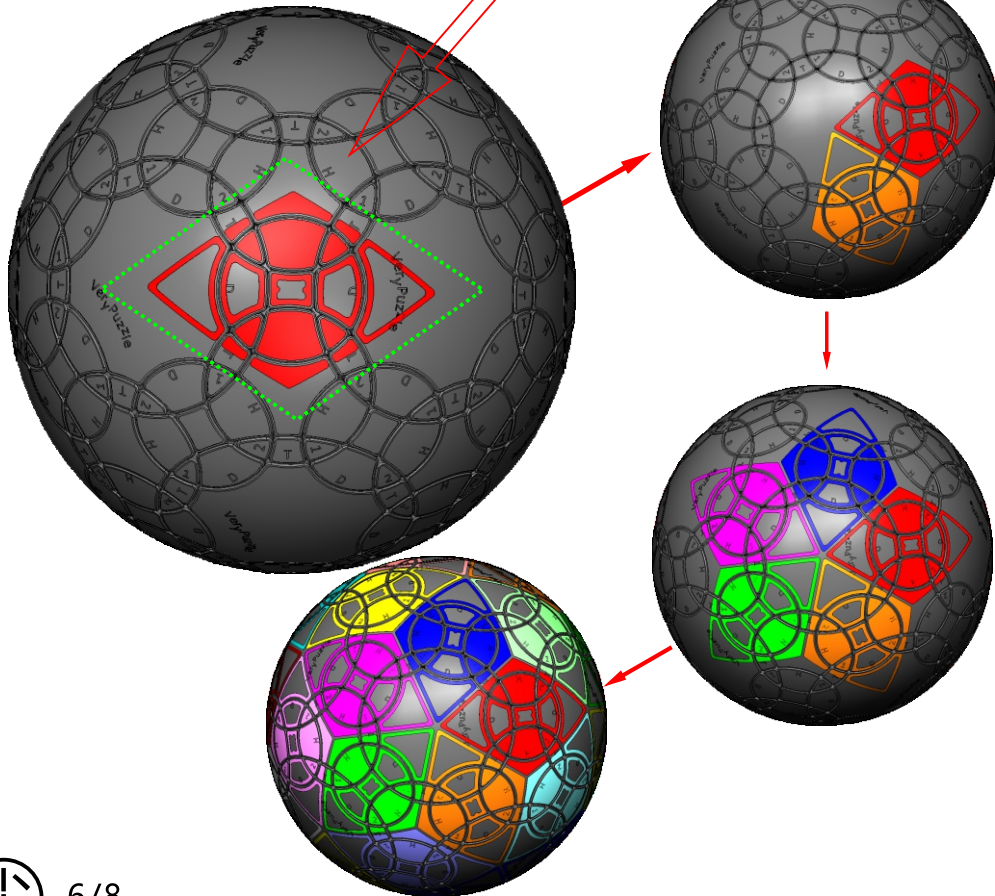

13

Rotation Rules

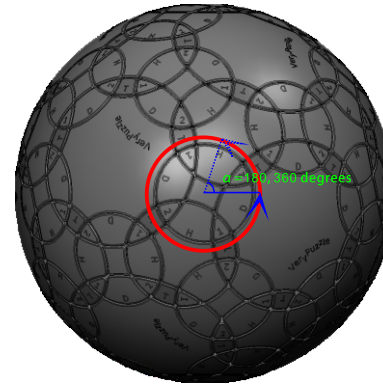

2-fold symmetry

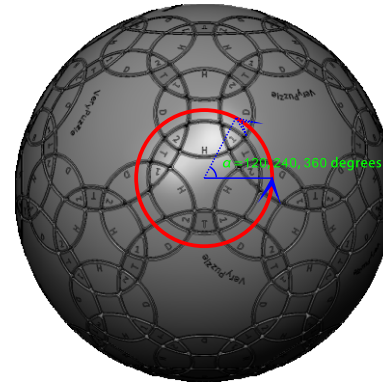

3-fold symmetry

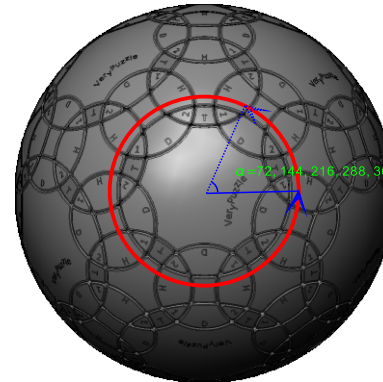

5-fold symmetry

Notations & Algorithms

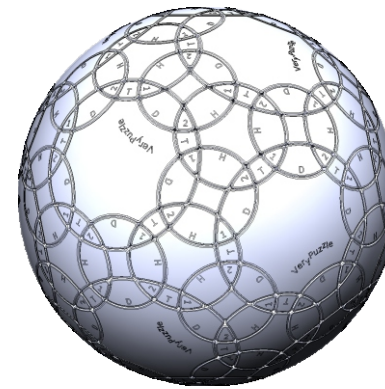
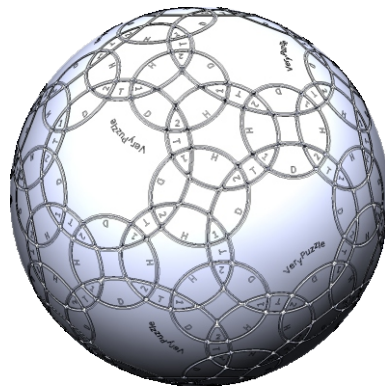
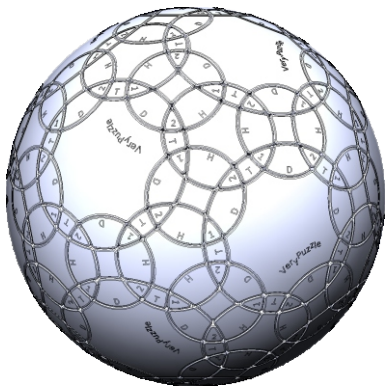
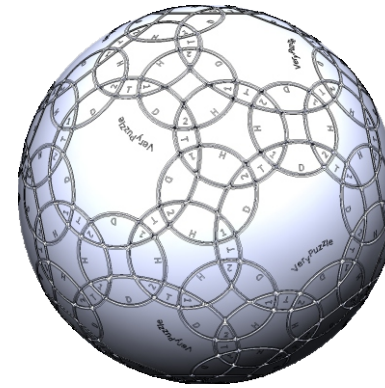
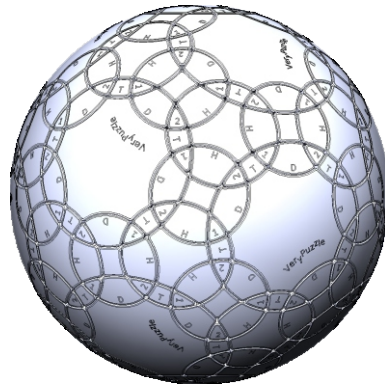
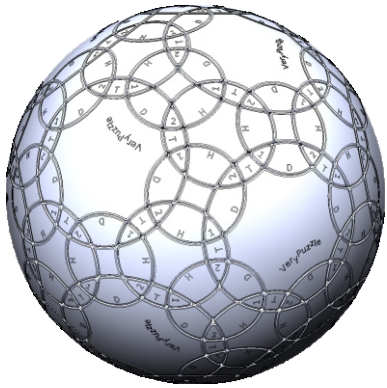
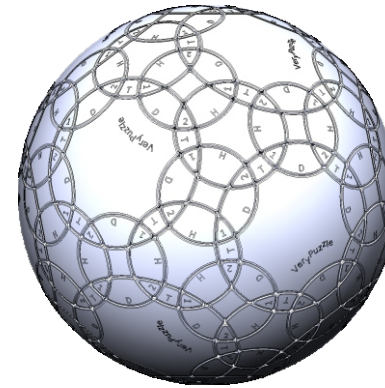
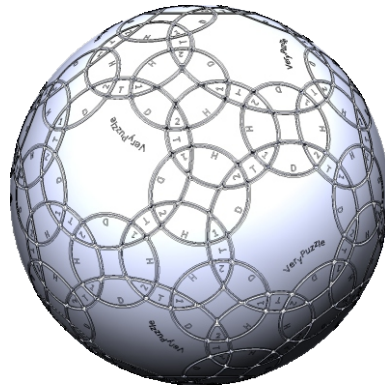
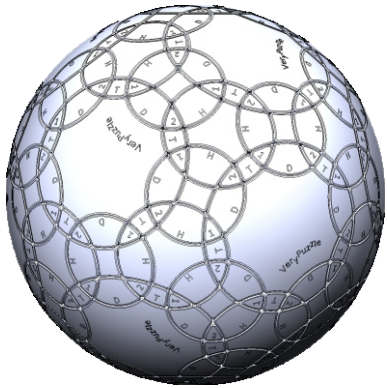

Product Information Card

Product Name	DIRT V1.0
Model NO.	#80
Design	VeryPuzzle Co., Ltd(HK)
Manufacturer	VeryPuzzle Co., Ltd(HK)
Year of release	2020
Maximum diameter	195 mm
Visible moving parts	362 pcs
Coloring strategy	simplified Delauney
Number of colors	30 colors
Sticker type	uniform matte
Sticker protection	Yes
Number of sticker pieces	510 pcs
Axis & Symmetry	D(C5)+I(C3)+RT(C2)
Maximum parts shared between two axes	3 parts
In-core spring	Yes
Adjustable tension	No
Technical Name	D1I1RT1
Topological Print	D27I17RT15
Core specification	DIRT180

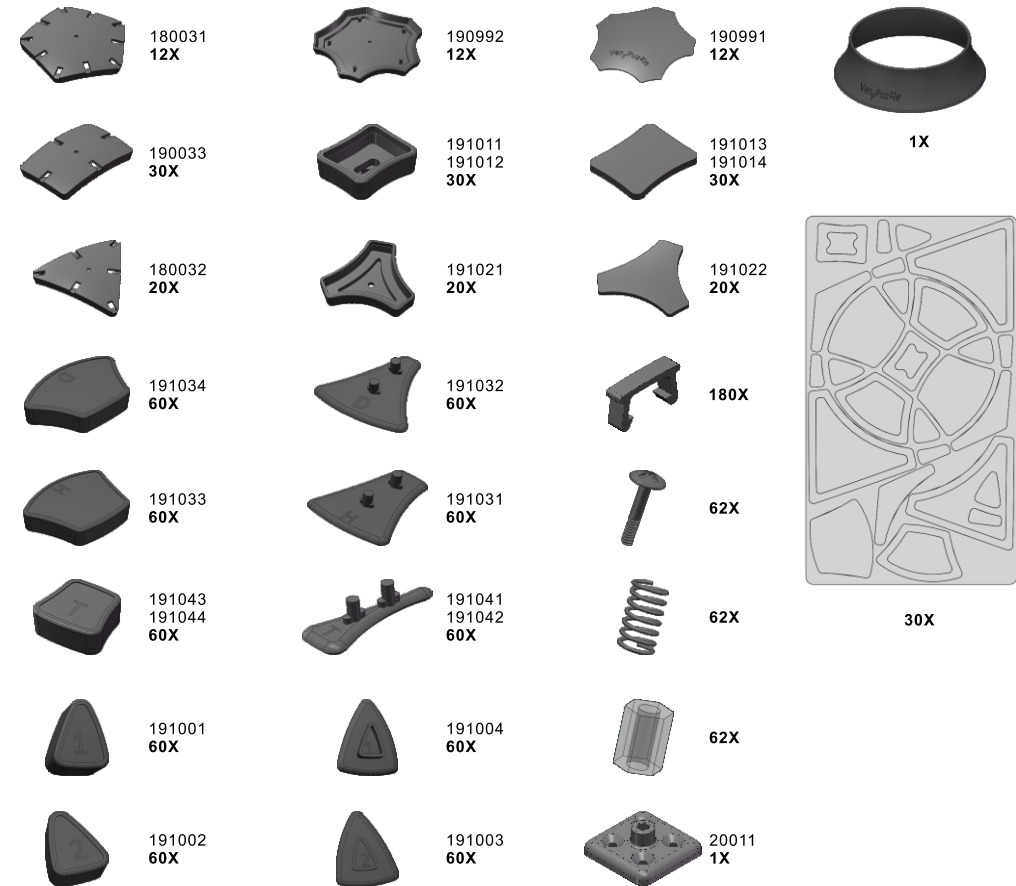

Customer Service

1. support@verypuzzle.com

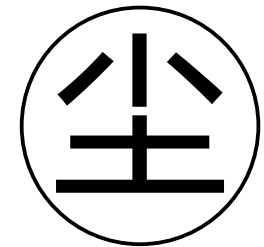

VeryPuzzle